

# GP FLOW SWITCH 101068

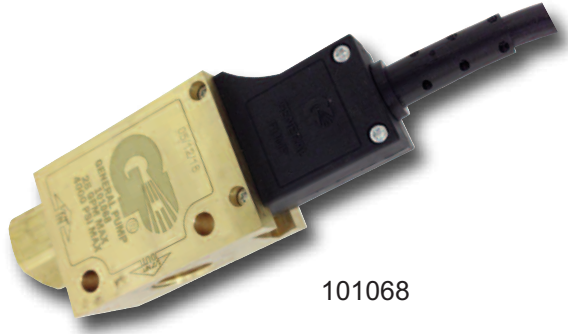

101068

## FEATURES

- Micro-switch technology eliminates reed switch
- Activation below 4.0 GPM
- Minimal pressure drop up to 25 gpm flow
- Mount in vertical position

## EXPLODED VIEW

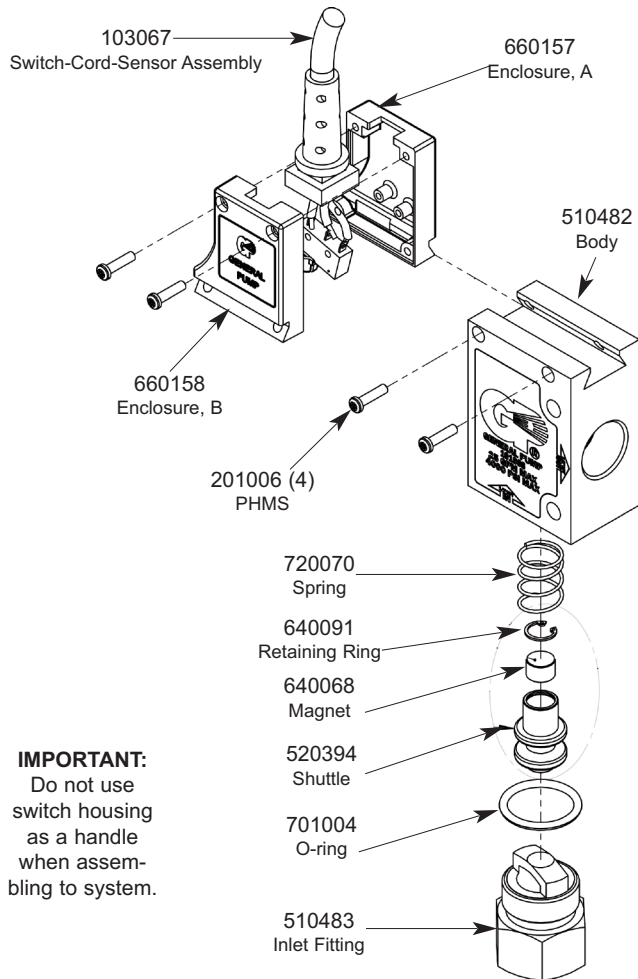

**IMPORTANT:**  
Do not use switch housing as a handle when assembling to system.

## SPECIFICATIONS

<b>Part Number</b>	<b>101068</b>	
<b>Maximum Operating Pressure</b>	3,000 PSI@25 GPM	4,000 PSI@10 GPM
<b>Minimum Flow Required for Activation</b>	4.0 GPM @ 50 PSI	
<b>Maximum Operating Flow</b>	25.0 GPM	
<b>Operating Temperature Range</b>	40 - 180 °F	
<b>Electrical Lead Length</b>	48" - 18AWG	
<b>Switch Ratings</b>	Max Switching Voltage	250 VAC
	Max Switching Current	5 AMPS
	Resistance with Leads	30 OHM
<b>Ports</b>	Inlet	1/2" NPT-F
	Outlet	1/2" NPT-F
<b>Dimensions</b>	6.3" x 2.0" x 1.3	
<b>Weight</b>	1.85 LBS	
<b>Materials</b>	Buna-N, Brass, Plastic, Nickel-plated Neodymium	

## DIMENSIONS AND WIRING SCHEMATIC

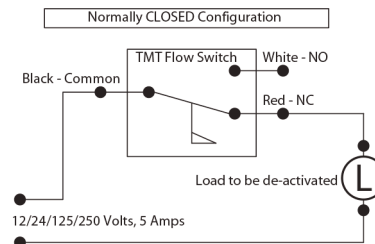
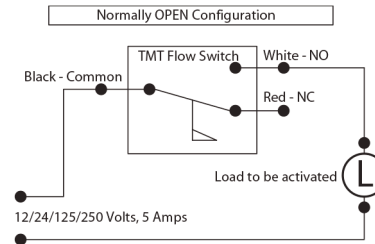
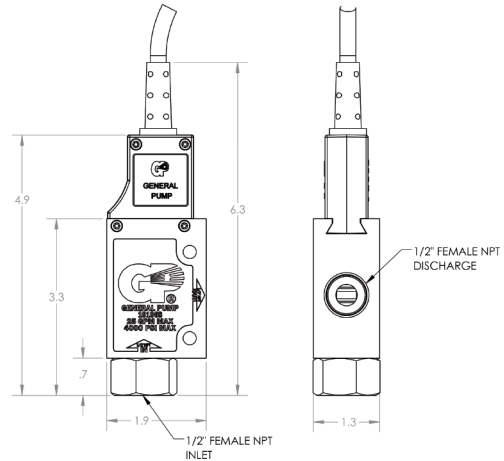

Ref 310028 Rev. B  
07-16

